

押さえプレート表面20mm止メタイプ パネル厚35・40・46・50用

中間止メ用

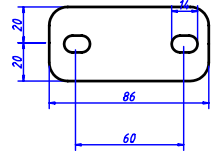

29-UW-20-35

29-UW-20-40

29-UW-20-46

29-UW-20-50

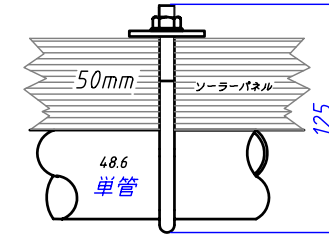
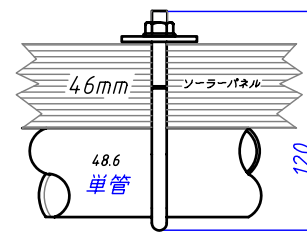
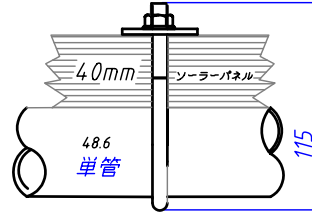
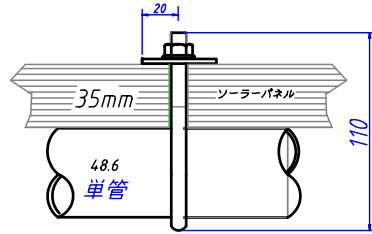
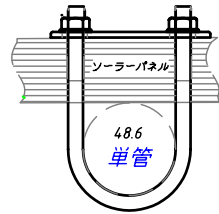

端止メ用

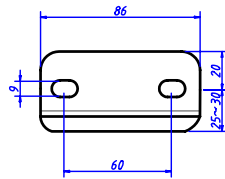

29-US-20-35

29-US-20-40

29-US-20-46

29-US-20-50

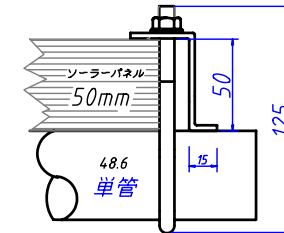
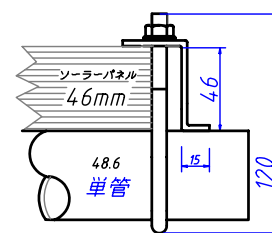
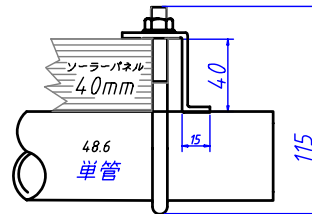
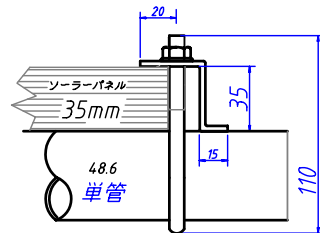
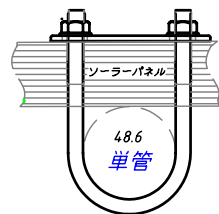

設計基準 荷重：P(止め金具へ垂直の荷重) Uボルトへかかる荷重

M8ボルトの有効断面積A : 36.6mm²

SUS304の耐力σ : 205N/mm²

M8ボルト許容応力P1 : $A \times \sigma = 36.6 \times 205 = 7.503N$

M8ボルト2本止めP : $2 \times 7.503 = 15.006N$

強度は設計基準を参照

荷重P

荷重P1 荷重P2

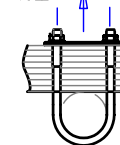

安全率(使用環境に応じて設定)ここでは静荷重として安全率3を設定しています。 $15.006 \div 3 = 5.002N$ (約500kg)